



**memmert**  
Experts in Thermostatics



# OPERATING INSTRUCTIONS

CENTRAL WATER SUPPLY FOR  
MEMMERT APPLIANCES WITH HUMIDITY CONTROL

100% ATMOSAFE. MADE IN GERMANY

[www.memmert.com](http://www.memmert.com) | [www.atmosafe.net](http://www.atmosafe.net)

## Manufacturer and customer service

Memmert GmbH + Co. KG  
Willi-Memmert-Straße 90-96  
D-91186 Büchenbach  
Deutschland

Phone: +49 (0)9122 925-0  
Fax: +49 (0)9122 14585  
E-mail: [sales@memmert.com](mailto:sales@memmert.com)  
Internet: [www.memmert.com](http://www.memmert.com)

### Customer service:

Service hotline: +49 (0)9171 9792 911  
Service fax: +49 (0)9171 9792 979  
E-mail: [service@memmert.com](mailto:service@memmert.com)

### Shipping address for repairs:

Memmert GmbH + Co. KG  
Kundenservice  
Willi-Memmert-Str. 90-96  
DE-91186 Büchenbach  
Germany

Please contact our customer service before sending appliances for repair or before returning equipment, otherwise, we have to refuse acceptance of the shipment.

© 2014 MEMMERT GmbH + Co. KG

Date 10/2014

We reserve the right to make changes

## About this manual

---

### Purpose and target audience

This instruction manual describes the setup, function, operation and maintenance of the central water supply for MEMMERT appliances with humidity control. It is intended for use by trained personnel of the owner, who have the task of operating and/or maintaining the respective appliance.

If you are asked to work on the appliance, read this manual carefully before starting. If there is something you do not understand, or certain information is missing, ask your manager or contact the manufacturer. Do not do anything without authorisation.

### Other documents that have to be observed:

- ▶ The instruction manuals for the MEMMERT appliances that are to be connected to the central water supply

### Storage and resale

This instruction manual belongs with the appliance and should always be stored where persons working on the appliance have access to it. It is the responsibility of the owner to ensure that persons who are working or will work on the appliance are informed as to the whereabouts of this instruction manual. We recommend that it is always stored in a protected location close to the appliance. Make sure that the instruction manual is not damaged by heat or humidity. If the appliance is resold or transported and then set up again at a different location, the operating instructions must go with it.

# Contents

<b>1. Construction, description and function</b>	<b>5</b>
1.1 Construction .....	5
1.2 Description.....	6
1.3 Function.....	6
1.4 Technical data .....	6
1.5 Intended use and improper use.....	6
1.6 Scope of delivery .....	7
1.7 Optional accessories/spare parts .....	7
<b>2. Putting into operation</b>	<b>8</b>
2.1 Setting up .....	8
2.2 Connecting .....	8
<b>3. Replacing filter cartridges</b>	<b>10</b>
3.1 Need to replace the filter cartridges.....	10
3.2 Removing covers .....	11
3.3 Replacing filter cartridges.....	12
3.4 Cleaning the water supply tank .....	13
3.5 Put the covers back on .....	14
3.6 Disposing of used filter cartridges.....	14

# 1. Construction, description and function

## 1.1 Construction

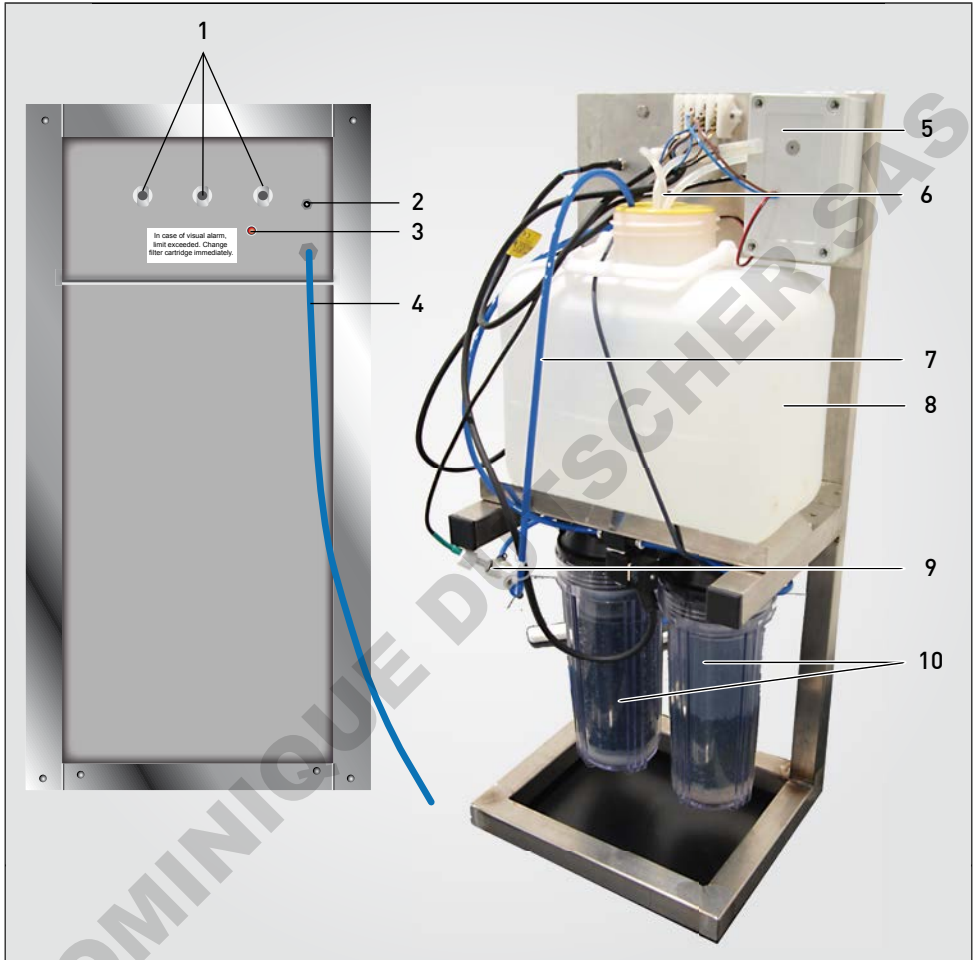

Fig. 1 Construction

- 1 Tube connections for one MEMMERT appliance with humidity control
- 2 Connection for power supply unit (12 V DC)
- 3 LED (warning display, if filter cartridge is empty)
- 4 Supply tube for tap water
- 5 Monitoring unit for water conductivity
- 6 Tubes from water supply tank to the tube connections on the front of the appliance (1)
- 7 Filling tube from the filter cartridge to the water supply tank
- 8 Water supply tank
- 9 Sensor for measuring conductivity of water from the filter cartridges
- 10 Filter cartridges in plexiglass containers

## 1.2 Description

The steam generator in MEMMERT appliances with humidity control is supplied with demineralised water from tanks that must be regularly refilled with commercially available demineralised water. Using demineralised water is imperative, as otherwise pumps and pipes could become calcified.

With a central water supply, up to three MEMMERT appliances with humidity control can be supplied with demineralised water. The tanks, and therefore refilling, are then no longer necessary.

## 1.3 Function

Via the supply tube (Fig. 1, No. 4), tap water is fed through the filter cartridges (10) and this way demineralised. The demineralised water is channelled, float controlled, to a water supply tank (8) connected (6) with three tube connectors to the front of the appliance (1). Up to three MEMMERT appliances with humidity control can be connected here.

The conductivity of the demineralised water – and thus the correct function of the filter cartridges – is measured continuously by a monitoring unit (5), supplied via the connection on the front of the appliance (2) with 12 V direct current by the included plug-in power supply unit. If the conductivity exceeds a certain value, the LED at the front will flash (3, see also page 10) and a warning signal will sound. Then, the filter cartridges must be replaced (see page 10).

## 1.4 Technical data

Height (mm)	735
Width (mm)	355
Depth (mm)	255
Weight [kg]	15 (with empty water supply tank)
Power supply	12 V DC via power supply unit 230/110 V AC

## 1.5 Intended use and improper use

The central water supply must only be used to supply MEMMERT appliances with humidity control with demineralised water. Any other use is improper, and may result in damage. In particular,

- ▶ connecting other appliances to the central water supply is not permissible
- ▶ filling the central water tank with fluids other than drinking water with a pressure of maximum 2.5 bar and a maximum temperature of 40 °C
- ▶ operation with other filter inserts than those provided by the manufacturer
- ▶ attaching and fitting parts not approved by the manufacturer

## 1.6 Scope of delivery

- ▶ central water supply
- ▶ power supply unit 230/110 V AC → 12 V DC
- ▶ water supply tube 2 m
- ▶ filter key
- ▶ the operating instructions at hand

## 1.7 Optional accessories/spare parts

- ▶ connection tube for MEMMERT appliances (order No. B04310, length 2 m)
- ▶ replacement filter cartridge (order No. E06290)

DOMINIQUE DUTSCHER SAS

## 2. Putting into operation

### Caution:

- 1 After putting it into operation, do not initially leave the appliance unattended. Check whether there are any leaks, i.e. if water comes out anywhere.

### 2.1 Setting up

The following must be available at the installation location:

- ▶ a mains supply 230 or 110 V AC
- ▶ a connection to the water supply (water tap) 3/4"

### 2.2 Connecting

(See connection diagram. Fig. 3)

1. Connect every MEMMERT appliance that is to be supplied with demineralised water to the central water supply. To do so, connect the water pipe of the appliance, which is normally connected to its water tank, to one of the three connections at the front of the central water supply (Fig. 3, No. 1). Push the tube into the connection. It is automatically locked. Read the operating instructions of the respective appliance when doing this.

- 1 If the water tubes are too short, you can purchase longer tubes from MEMMERT (see Chapter 1.7 Optional accessories/spare parts on page 7).

For tube removal, push the metal bracket on the connection upwards and pull off the tube.

2. Connect the water supply tube provided to the front of the central water supply. Connect the other end (coupling) to a 3/4" water tap (2).

### Caution:

- 1 The water from the water supply must not be warmer than 40 °C, not have a pressure higher than 2.5 bar and must be capable of being shut off. If necessary, install a pressure reducer and/or a stop valve.
3. Connect the supplied power supply unit of the central water supply to the mains supply (230/110 V AC) (3). The power supply unit provided is equipped with adapters for various socket types, which automatically adjust the power supply unit to the correct input voltage. Push the appropriate adapter, as shown in Fig. 2 on to the power supply unit.



Fig. 2 Push on the power supply unit adapter

4. Turn on the water tap. The central water supply is now operational. The connected appliances can be switched on.

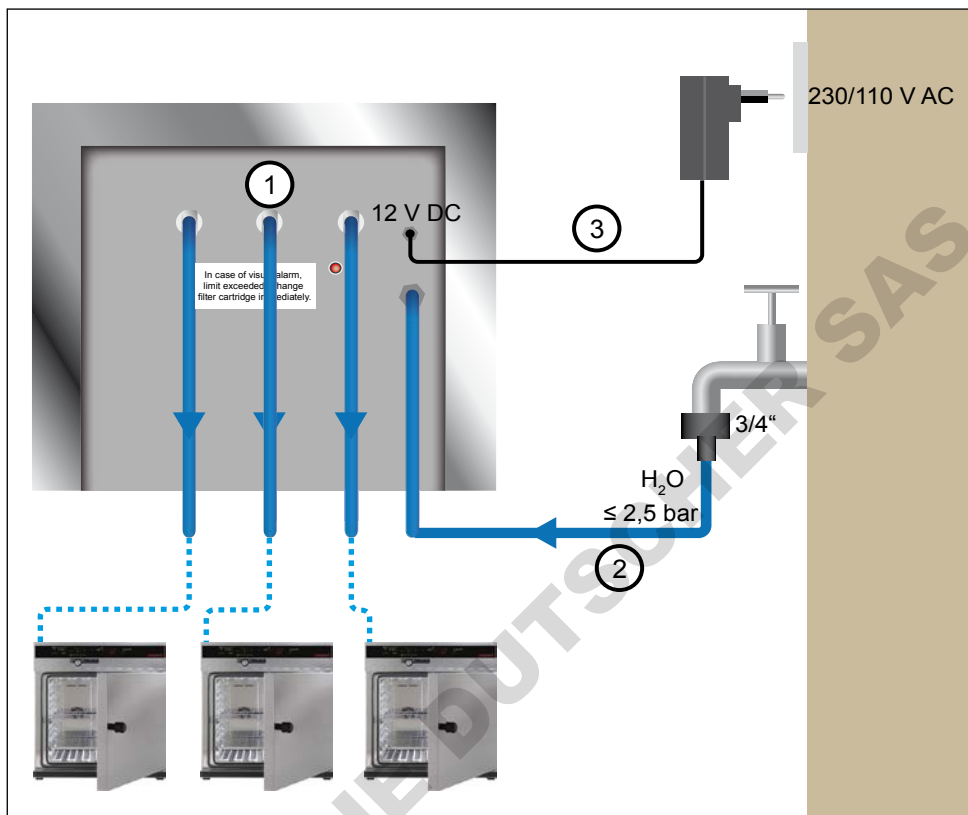

Fig. 3 Connection diagram  
 1 Connect ovens  
 2 Establish water supply  
 3 Establish power supply

## 3. Replacing filter cartridges

### 3.1 Need to replace the filter cartridges

The filter cartridges, which demineralise the tap water, are used up after a certain period of time. How long they last depends on the number of appliances connected and their operating time, as well as the degree of humidity set and the quality of the supplied tap water.

When the filter cartridges are used up, the LED at the front of the central water supply flashes (Fig. 4) and a warning signal sounds for about 20 seconds. The conductivity of the filtered water will then no longer correspond to the requirements made of demineralised water.

When the warning is set off, there is still approx. 10 litres of demineralised water in the water supply tank of the central water supply. This means that the appliances can still be temporarily operated. The filter cartridges should be replaced as soon as possible, however, to prevent untreated tap water getting into the appliances at some point and possibly damaging them.

Two replacement filter cartridges are required. These can be obtained from MEMMERT under order No. E06290.

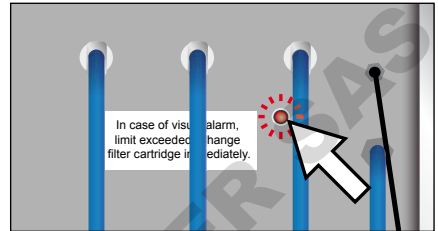
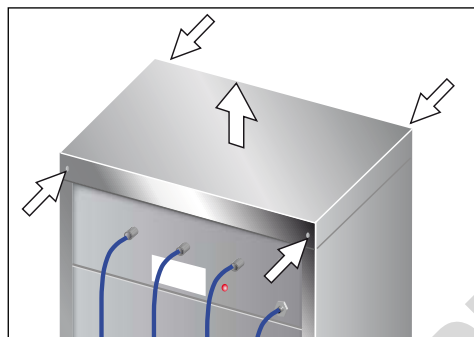

Fig. 4  
Warning filter cartridges used

## 3.2 Removing covers

In order to replace the filter cartridges, the covers of the central water supply must first be removed.

1. Switch off any appliances connected.
2. Unplug the power supply unit from the socket and remove the 12-V connection plug from the central water supply.
3. Turn off the water tap.
4. Dismantle the cover of the central water supply. To do so, remove the four screws at the front and back and lift off the cover (Fig. 5).
5. Undo the fastening screws of the side and rear cover (U-shaped profile) and remove the profile (Fig. 6). The filter cartridges can now be accessed at the rear.



*Fig. 5  
Remove fastening screws of the cover  
and take off cover*

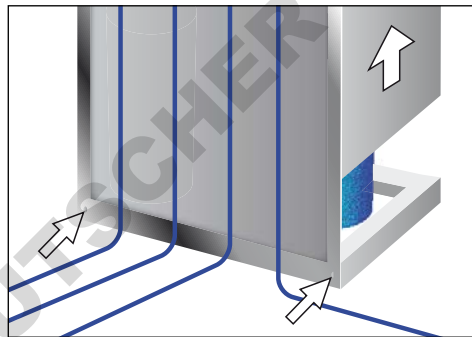

*Fig. 6  
Undo the fastening screws of the side  
and rear cover (U-shaped profile)  
and remove the profile*

### 3.3 Replacing filter cartridges

**Caution:**

**1** Always replace both filter cartridges.

1. Unscrew the two cartridge holders from the fixtures using the supplied filter spanner (Fig. 7).
2. Take out the used cartridges and insert the replacement cartridges (Fig. 8).

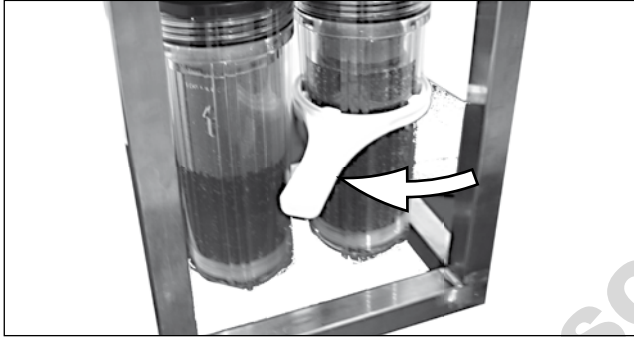

Fig. 7  
Unscrew cartridge holders with filter spanner



Fig. 8  
Remove cartridges and insert new ones

3. Tighten the two cartridge holders again.
4. Check for tightness. To do so, re-establish the water supply (open water tap). If water escapes from the screw connections of the cartridge holders, tighten the cartridges more firmly with the filter spanner.

### 3.4 Cleaning the water supply tank

Clean the water supply tank each time you change the filters, but at least once per year.

Reason: Over time, deposits will form on the inner walls.

1. Switch off the water supply (turn off water tap, in case it is on).
2. Pull off the connection lines of the floating switch from the terminal strip (Fig. 9, No. 1).
3. Pull the three feed pipes to the appliance connections (2) and the water supply tube (3) from the filter cartridges and through the cover of the water supply tank.
4. Remove the attachment of the water supply tank (rubber band, 4).
5. Take off the water supply tank. Remove the cover and empty the tank.
6. Clean the inside of the tank with standard washing-up liquid and a brush and then rinse it thoroughly with demineralised water.

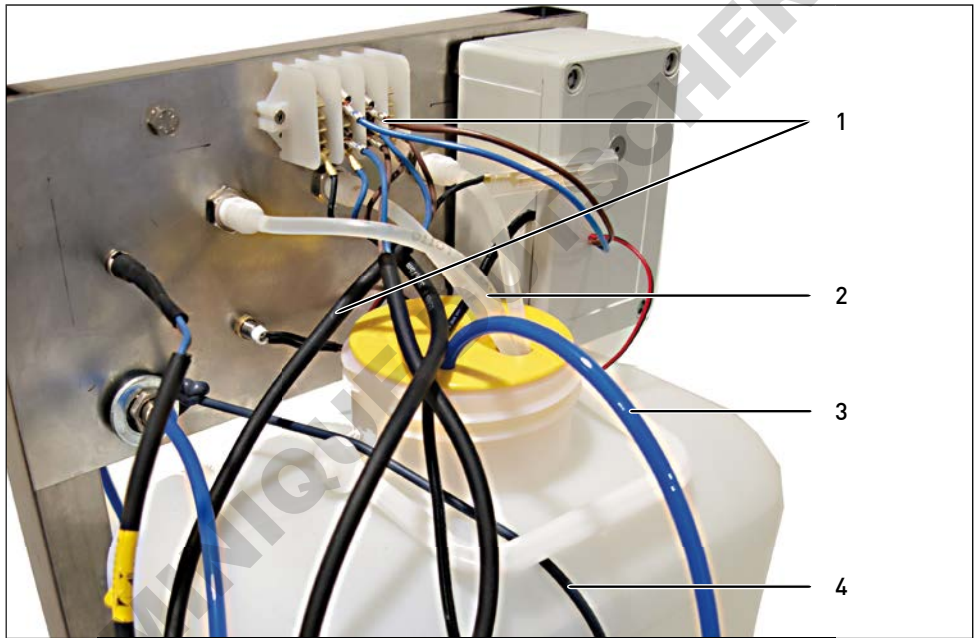

Fig. 9 Dismantle the water supply tank

- 1 Connection lines of the floating switch
- 2 Feed pipes to the appliance connections
- 3 Water supply tube
- 4 Attachment (rubber band)

7. Put the cover of the water supply tank back on. Place the tank back in its holder and fasten it with the rubber band.
8. Push the three feed pipes to the appliance connections (2) and the water supply tube (3) from the back through the cover into the water supply tank.
9. Plug the connection lines of the floating switch (1) back onto the terminal strip. Check that the floating switch moves freely in the water supply tank.

### 3.5 Put the covers back on

1. Carefully push the side and rear cover (U-shaped profile) back on and tighten (Fig. 10). When doing so, make sure that no lines or tubes get squashed, bent or damaged.
2. Put the cover back on and fasten with four screws (Fig. 11).

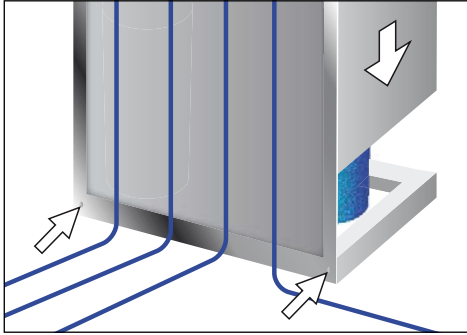

*Fig. 10*  
Push the side and rear cover (U-shaped profile) back on and screw tight

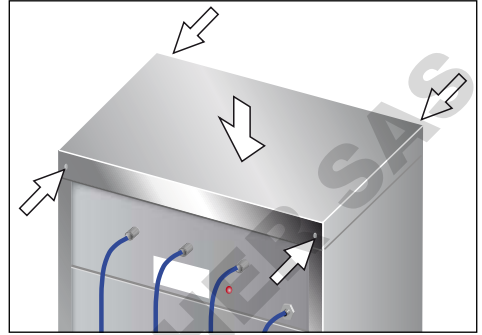

*Fig. 11*  
Put the cover back on and fasten it

3. Connect the power supply unit to the mains supply and the 12-V connection at the front to the central water supply.
4. Re-establish the water supply (open water tap).
5. Put humidity chambers back into operation. Check that there are no leaks in the water supply. If water should leak out: Check the tube connections. If water is leaking from the bottom of the central water supply: Undo covers again, look for the leak and eliminate it.

### 3.6 Disposing of used filter cartridges

Used filter cartridges can be disposed of in normal household waste.

**DOMINIQUE DUTSCHER SAS**



# memmert

Experts in Thermostatics

DOMINIQUE DUTSCHER SAS

Central Water Supply

D24061 | Date 10/2014

englisch

Memmert GmbH + Co. KG  
Willi-Memmert-Straße 90-96 | D-91186 Büchenbach  
Tel. +49 9122 925-0 | Fax +49 9122 14585  
E-Mail: [sales@memmert.com](mailto:sales@memmert.com)  
[facebook.com/memmert.family](https://facebook.com/memmert.family)  
Die Experten-Plattform: [www.atmosafe.net](http://www.atmosafe.net)