

Thermo Scientific Matrix 2D Barcoded ScrewTop Storage Tubes are the perfect solution for sample storage in virtually any laboratory condition, including the vapor phase of liquid nitrogen. Permanent 2D barcodes enable safe, secure tracking of all precious samples while Thermo Scientific 2D barcode readers allow simple integration into an existing database or tracking system.

Thermo Scientific Matrix 2D Barcoded ScrewTop Storage Tubes



Secure Tracking. A permanently-bonded, unique 2D barcode is laser-etched onto the base of every Thermo Scientific Matrix 2D Barcoded ScrewTop Storage Tube to securely identify and track samples. A Thermo Scientific 2D barcode reader instantly decodes each tube's 2D barcode, scans the tube into any application or database, or integrates via several export options. Once sample data is stored, just scan the tube to access sample information and identify the contents.

Flexibility. The Thermo Scientific Matrix ScrewTop Removal Tool decaps/decaps tubes individually to enable one-handed pipetting. The Thermo Scientific ScrewTop Cap Tray can be used to cap/decap several tubes at once with automated capping systems or to fill tubes on an automated liquid handling platform, then cap an entire rack at once.

Stringent Quality Control. Every 2D barcoded storage tube is scanned to ensure readability. All barcodes are checked against our database of previously assigned codes to prevent duplicates. Every tube is leak tested to ensure sample integrity and security.

Superior Storage Format. Matrix® 2D Barcoded ScrewTop® storage tubes are available in specially-designed, stackable, microplate-footprint Latch Racks to save precious space in storage and on the bench top. The Latch Rack design enables multichannel pipette access. When open, the lid never touches the bench top to prevent contamination.



Ordering Guide

| Cat. No. | Description | Color | Qty | |
|----------|--|----------------|-------------------------|---------|
| 4470 | Caps, ScrewTop Tube | Colorless | 500/case | Sterile |
| 4470RED | Caps, ScrewTop Tube | Red | 500/case | Sterile |
| 4470YEL | Caps, ScrewTop Tube | Yellow | 500/case | Sterile |
| 4470BLU | Caps, ScrewTop Tube | Blue | 500/case | Sterile |
| 4470GRE | Caps, ScrewTop Tube | Green | 500/case | Sterile |
| 4470WHI | Caps, ScrewTop Tube | White | 500/case | Sterile |
| 4470PUR | Caps, ScrewTop Tube | Purple | 500/case | Sterile |
| 4906 | Tray, ScrewTop Cap Tray, Empty | | 5 trays/case | Sterile |
| 4477 | Tray, ScrewTop Cap Tray | Colorless Caps | 5 trays of 96 caps/case | Sterile |
| 4477RED | Tray, ScrewTop Cap Tray | Red Caps | 5 trays of 96 caps/case | Sterile |
| 4477YEL | Tray, ScrewTop Cap Tray | Yellow Caps | 5 trays of 96 caps/case | Sterile |
| 4477BLU | Tray, ScrewTop Cap Tray | Blue Caps | 5 trays of 96 caps/case | Sterile |
| 4477GRE | Tray, ScrewTop Cap Tray | Green Caps | 5 trays of 96 caps/case | Sterile |
| 4477WHI | Tray, ScrewTop Cap Tray | White Caps | 5 trays of 96 caps/case | Sterile |
| 4477PUR | Tray, ScrewTop Cap Tray | Purple Caps | 5 trays of 96 caps/case | Sterile |
| 3740 | Tube, ScrewTop, 1.0 mL 2D, V-Bottom | Colorless Caps | Bulk, 480/case | Sterile |
| 3740RED | Tube, ScrewTop, 1.0 mL 2D, V-Bottom | Red Caps | Bulk, 480/case | Sterile |
| 3740YEL | Tube, ScrewTop, 1.0 mL 2D, V-Bottom | Yellow Caps | Bulk, 480/case | Sterile |
| 3740BLU | Tube, ScrewTop, 1.0 mL 2D, V-Bottom | Blue Caps | Bulk, 480/case | Sterile |
| 3740GRE | Tube, ScrewTop, 1.0 mL 2D, V-Bottom | Green Caps | Bulk, 480/case | Sterile |
| 3740WHI | Tube, ScrewTop, 1.0 mL 2D, V-Bottom | White Caps | Bulk, 480/case | Sterile |
| 3740PUR | Tube, ScrewTop, 1.0 mL 2D, V-Bottom | Purple Caps | Bulk, 480/case | Sterile |
| 3741 | Tube, ScrewTop, 1.0 mL 2D, V-Bottom | Colorless Caps | 5 racks of 96/case | Sterile |
| 3741RED | Tube, ScrewTop, 1.0 mL 2D, V-Bottom | Red Caps | 5 racks of 96/case | Sterile |
| 3741YEL | Tube, ScrewTop, 1.0 mL 2D, V-Bottom | Yellow Caps | 5 racks of 96/case | Sterile |
| 3741BLU | Tube, ScrewTop, 1.0 mL 2D, V-Bottom | Blue Caps | 5 racks of 96/case | Sterile |
| 3741GRE | Tube, ScrewTop, 1.0 mL 2D, V-Bottom | Green Caps | 5 racks of 96/case | Sterile |
| 3741WHI | Tube, ScrewTop, 1.0 mL 2D, V-Bottom | White Caps | 5 racks of 96/case | Sterile |
| 3741PUR | Tube, ScrewTop, 1.0 mL 2D, V-Bottom | Purple Caps | 5 racks of 96/case | Sterile |
| 3742 | Tube, ScrewTop, 1.0 mL 2D, V-Bottom, No Caps | | 5 racks of 96/case | Sterile |
| 3743 | Tube, ScrewTop, 500 µl 2D, V-Bottom | Colorless Caps | Bulk, 480/case | Sterile |
| 3743RED | Tube, ScrewTop, 500 µl 2D, V-Bottom | Red Caps | Bulk, 480/case | Sterile |
| 3743YEL | Tube, ScrewTop, 500 µl 2D, V-Bottom | Yellow Caps | Bulk, 480/case | Sterile |
| 3743BLU | Tube, ScrewTop, 500 µl 2D, V-Bottom | Blue Caps | Bulk, 480/case | Sterile |
| 3743GRE | Tube, ScrewTop, 500 µl 2D, V-Bottom | Green Caps | Bulk, 480/case | Sterile |
| 3743WHI | Tube, ScrewTop, 500 µl 2D, V-Bottom | White Caps | Bulk, 480/case | Sterile |
| 3743PUR | Tube, ScrewTop, 500 µl 2D, V-Bottom | Purple Caps | Bulk, 480/case | Sterile |
| 3744 | Tube, ScrewTop, 500 µl 2D, V-Bottom | Colorless Caps | 5 racks of 96/case | Sterile |
| 3744RED | Tube, ScrewTop, 500 µl 2D, V-Bottom | Red Caps | 5 racks of 96/case | Sterile |
| 3744YEL | Tube, ScrewTop, 500 µl 2D, V-Bottom | Yellow Caps | 5 racks of 96/case | Sterile |
| 3744BLU | Tube, ScrewTop, 500 µl 2D, V-Bottom | Blue Caps | 5 racks of 96/case | Sterile |
| 3744GRE | Tube, ScrewTop, 500 µl 2D, V-Bottom | Green Caps | 5 racks of 96/case | Sterile |
| 3744WHI | Tube, ScrewTop, 500 µl 2D, V-Bottom | White Caps | 5 racks of 96/case | Sterile |
| 3744PUR | Tube, ScrewTop, 500 µl 2D, V-Bottom | Purple Caps | 5 racks of 96/case | Sterile |
| 3745 | Tube, ScrewTop, 500µL 2D, V-Bottom, No Caps | | 5 racks of 96/case | Sterile |

© 2009 Thermo Fisher Scientific Inc. All rights reserved. All trademarks are the property of Thermo Fisher Scientific Inc. and its subsidiaries.

North America: Tel: 800.345.0206 | email: matrix_info@thermofisher.com
 Europe: Tel: +44 (0) 161 486 2110 | email: matrix_eu.info@thermofisher.com
 Asia: email: matrix_ap.info@thermofisher.com

www.thermo.com/matrix

Thermo
SCIENTIFIC

Part of Thermo Fisher Scientific

Thermo
SCIENTIFIC

Thermo Scientific Matrix 2D Barcoded ScrewTop Storage Tubes

| | |
|----------------------------|--|
| Tube Material | Virgin Class VI Medical Grade Polypropylene |
| Rack Material | Virgin Class VI Medical Grade Polycarbonate with polypropylene latches |
| Cap Material | Virgin Class VI Medical Grade Polypropylene with Virgin Class VI Medical Grade Silicone O-ring |
| Autoclavable | Yes, with cap loosened |
| 2D Code Choices | Non-proprietary, 12x12 Data-matrix with ECC200 Built-in Error Correction |
| Tube/Cap Temp Range | -180 °C to 121 °C; Autoclaving and boiling to vapor phase liquid nitrogen storage |
| ScrewTop Cap Tray Material | Acrylonitrile Butadiene Styrene (ABS) |

* All tubes and trays are supplied free from DNA, RNase, DNase, endotoxins and cytotoxins. Tubes should be tested under individual laboratory conditions

Dimensions

| Description | | 500 µl ScrewTop Storage Tubes | 1.0 ml ScrewTop Storage Tubes |
|--|-------------------------|-------------------------------|-------------------------------|
| Item No | | 3743, 3744, 3745 | 3740, 3741, 3742 |
| Figure 1A: Tube Side View | Width (1A) | 7.40±0.10 [0.290±0.002] | 7.40±0.10 [0.290±0.002] |
| | Height (1A) | 30.60±0.20 [1.204±0.007] | 44.00±0.10 [1.732±0.003] |
| Figure 1B: Tube Side View w/ ScrewTop | Width (1B) | 8.70±0.10 [0.344±0.003] | 8.70±0.10 [0.344±0.003] |
| | Height (1B) | 39.20 [1.543] | 52.60 [2.071] |
| Figure 2: Rack Side View | Height (2A) | 29.50±0.10 [1.160±0.005] | 38.10±0.10 [1.500±0.005] |
| | Height (2B) | 29.10±0.10 [1.145±0.005] | 42.50±0.20 [1.673±0.008] |
| | Height (2C) | 32.60±0.30 [1.282±0.012] | 46.00±0.20 [1.809±0.008] |
| | Height (2D) | 41.30±0.40 [1.626±0.017] | 54.60±0.30 [2.149±0.110] |
| Figure 3: Rack Top View | Length | 127.75±0.13 [5.029±0.005] | 127.75±0.13 [5.029±0.005] |
| | Width | 85.46±0.13 [3.364±0.005] | 85.46±0.13 [3.364±0.005] |
| Figure 4: Stacked Rack View | Single Height (4A) | 44.32±0.25 [1.745±0.010] | 58.42±0.25 [2.300±0.010] |
| | Incremental Height (4B) | 43.31±0.25 [1.705±0.010] | 57.30±0.25 [2.220±0.010] |
| | Stacked Height (4C) | 87.63±0.51 [3.450±0.020] | 114.81±0.51 [4.520±0.020] |

| Description | | ScrewTop Cap Tray |
|------------------------------------|-------------------------|--------------------------|
| Item No. | | 4906, 4477 |
| Figure 1: Tray Top View | Length | 127.75±0.25 [5.03±0.010] |
| | Width | 85.580.25± [3.37±0.010] |
| Figure 2: Stacked Tray View | Single Height (2A) | 19.81±0.13 [0.78±0.005] |
| | Incremental Height (2B) | 18.29±0.25 [0.72±0.010] |
| | Stacked Height (2C) | 38.10±0.25 [1.50±0.010] |



Available in seven colors (including colorless) so you can customize your experiments

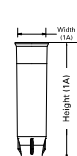
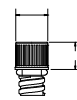

▲ Figure 1: Tube Side View

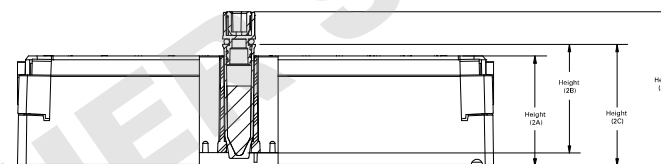
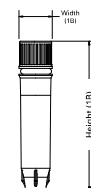

▲ Figure 2: Rack Side View

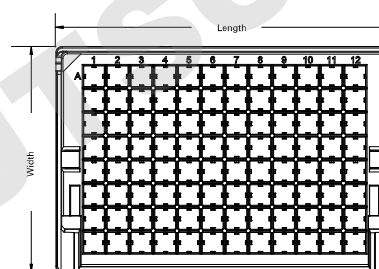

▲ Figure 3: Rack Top View

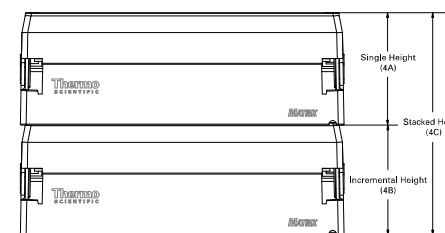

▲ Figure 4: Stacked Rack View

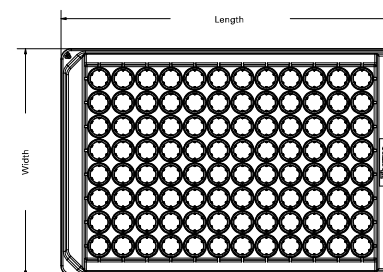

▲ Figure 1: Tray Top View



▲ Figure 2: Stacked Tray View