

High cabinet with blind doors and open top

Description:

- ✓ Cabinets are made of 19mm thickness melamine faced chipboard with ABS edges
- ✓ 2 lower doors with hinges that can open at 270° angle
- ✓ 1 fixed and 3 adjustable shelves (5 compartments) all over the height every 32mm
- ✓ Steel handles
- ✓ Height adjustable plinth
- ✓ Must be attached to the wall (*screws for mounting to the wall not included*)
- ✓ Color: light grey (similar to RAL 7035)
- ✓ NET weight 69 kg
- ✓ Max load on one shelf 30 kg

Suitable for :

- ✓ Storage of tools, accessories and labware

Not suitable for :

- ✓ Storage of acids and alkali
- ✓ Storage of flammable substances

Dimensions :

- ✓ Length 900mm
- ✓ Depth 370mm
- ✓ Height 1910mm

Available other options and not standard modifications under request

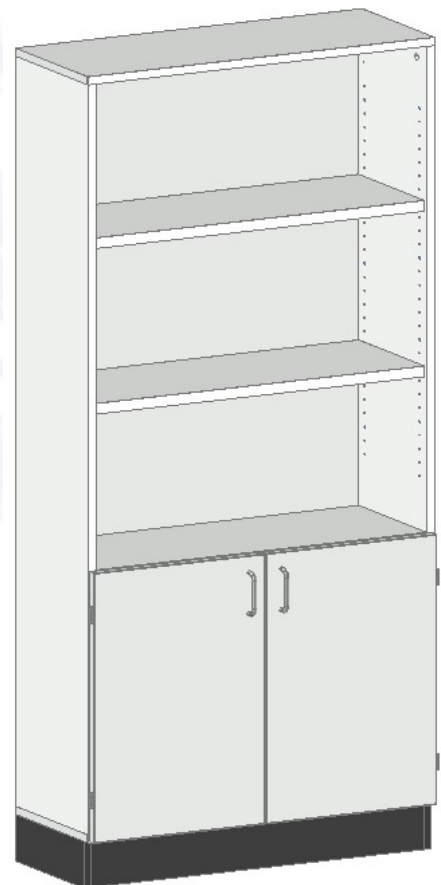

Sample picture