

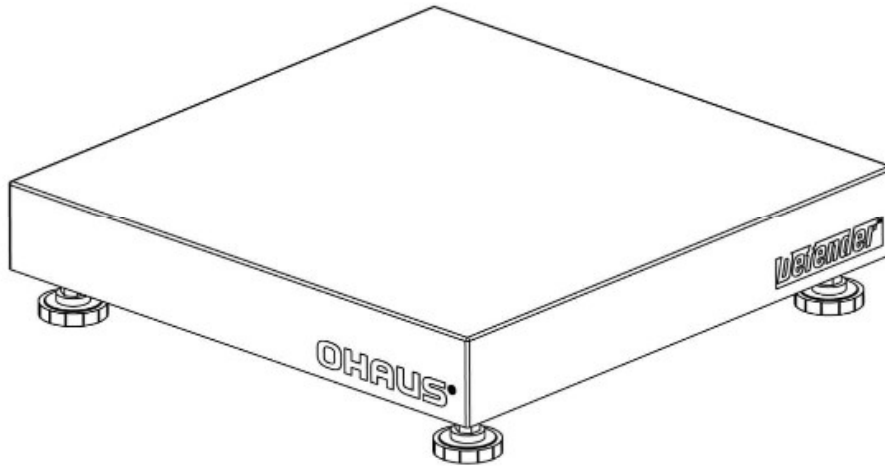

# Defender™ 6000 Series Base Instruction Manual



EN

ES

FR

DE

IT

PT

SE

NL

DK

PL

CZ

HU



# INTRODUCTION

This manual covers installation, and maintenance instructions for the OHAUS Defender™ Series Base. Please read this manual completely before installation and operation.

## SAFETY PRECAUTIONS

For safe and dependable operation of this product, please comply with the following precautions:



- Operate the base only under ambient conditions specified in these instructions
- Ensure that the load cell cable does not pose an obstruction or tripping hazard
- Do not operate the base in hazardous environments or unstable locations
- Do not drop loads on the base
- Do not lift the base by the top frame; always lift from the bottom frame when moving the base
- Service should only be performed by authorized personnel

## INSTALLATION

### Unpacking

Unpack and inspect the product to make sure that all components have been included. The package includes the following:

- Defender™ Series Base
- Weighing Pan
- Instruction Manual

When purchased as a complete Defender Series Scale, the package will also include:

- Indicator
- Column Assembly

## ASSEMBLY

### Weighing Pan

Remove the shipping spacers, and place the weighing pan securely over the rubber load pads on the top frame of the base.

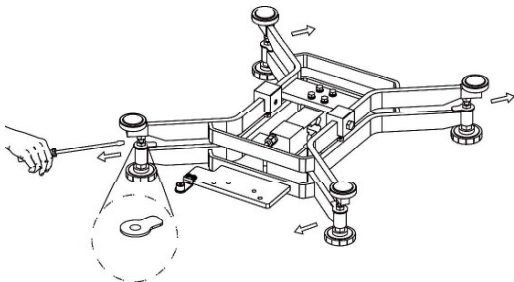

**Note:** Not included with some models

### Wiring Connections

When connecting the base to an OHAUS indicator equipped with the matching circular connector, push the base connector onto the indicator connector and turn the locking ring clockwise to lock it in place.

When connecting the base to an indicator that does not have the matching connector, install the optional load cell cable adapter (P/N 30429931 sold separately) to the indicator using the wiring codes in Table 1. Then attach the load cell cable to the cable adapter.

**Note:** As an alternate wiring method, cut off the connector, strip the wires and attach them to the indicator using the wiring codes in Table 1.

The extension cable accessory (P/N: 30429931) cannot be used if the scale will be used in a legal for trade or legally controlled application, because there is no provision to seal the connection between the indicator and platform.

TABLE 1. LOAD CELL CONNECTION

Type1. For model i-D3K1S, i-D6K1S, i-D15K1R, i-D30K1R, i-D60K1L bases

FUNCTION	WIRE COLOR
+ Excitation	Blue
- Excitation	Black
+ Signal	White
- Signal	Red
+ Sense	Green
- Sense	Grey
Shield	Yellow

Type2. For model i-D150K1L base

FUNCTION	WIRE COLOR
+ Excitation	Green
- Excitation	Black
+ Signal	White
- Signal	Red
+ Sense	Light Yellow
- Sense	Blue
Shield	Deep Yellow

## Selecting the Location

To ensure accuracy, proper performance and safety, locate and operate the base on a stable, level surface. Avoid locations with rapid temperature changes or excessive dust, air currents, vibrations, electromagnetic fields or heat.

Level the base by adjusting the four leveling feet until the bubble in the level indicator is centered. A wrench may be needed to loosen the locking nut above each leveling foot. When the base is level, retighten the locking nuts up against the base to lock each foot into place.

Note: Ensure that the base is level each time its location is changed.

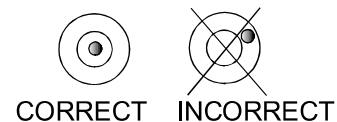

## MAINTENANCE

### Cleaning

The base components should be kept clean and free of excessive material build up.

- A damp cloth with water and a mild detergent may be used to wipe clean the external surfaces – do not use acids, alkalis, strong solvents or abrasive materials.

To maintain surface integrity, do not allow debris to remain on the surface of the painted or stainless steel base frame.

- Remove the pan and use fresh water to clean the base frame surface of any debris. Dry the base with a clean cloth or allow to air dry before replacing the pan. Repeat daily for best care.

## Troubleshooting

Aside from installing components and leveling adjustments, the Defender Series Base does not require any other adjustments as shipped from the factory.

Operational difficulties that may be encountered can often be traced to simple causes such as:

- Loose or incorrect wiring connections
- Failure to remove the shipping spacers
- Obstructions to the base frame
- Unstable environments
- Incorrect calibration or setup of the indicator

If the troubleshooting section does not resolve or describe your problem, contact your authorized OHAUS service agent. For service assistance or technical support in the United States, call toll-free 1-800-526-0659 between 8:00 AM and 5:00 PM EST. An OHAUS product service specialist will be available to provide assistance. Outside the USA, please visit our web site, [www.ohaus.com](http://www.ohaus.com) to locate the OHAUS office nearest you.

## TECHNICAL DATA

### Technical Specifications

The technical data is valid under the following ambient conditions:

Operating temperature: -10°C to +40 °C (14 °F to 104 °F)

Relative humidity: 100% relative humidity, non-condensing

Altitude: Up to 2,000m

**Note:** Not all models may be available in your area. Check with your local OHAUS representative.

**TABLE 2.1 SPECIFICATIONS**

MODEL	i-D3K1S	i-D6K1S	i-D15K1R	i-D30K1R	i-D60K1L	i-D150K1L
Capacity	3 kg	6 kg	15 kg	30 kg	60 kg	150 kg
Approved Resolution	OIML 3000e					
Safe Overload Capacity	150% of capacity					
Pan Dimensions	254 x 254 mm 10 x 10 in		305 x 305 mm 12 x 12 in		400 x 500 mm 15.7 x 19.6 in	
Base Construction	316 stainless steel top and bottom frame, hermetically sealed IP68/IP69K stainless steel loadcell.				316 stainless steel removable weighing platform with 316 stainless steel frame, hermetically sealed IP68/IP69K stainless steel loadcell.	
Repeatability (std.deviation)	2d					
Linearity	±2d					
Load Cell Capacity	10 kg	10 kg	20 kg	50 kg	100 kg	200 kg
Load Cell Cable	50cm L x 6-wire				1m L x 6-wire	
Load Cell Type	350 Ohm, SST, single point					
Load Cell Excitation	3.3-15V DC/AC					
Load Cell Rated Output	2mV/V					
Load Cell Protection	IP69K					
Net Weight	6 kg / 13.2 lb		7.5 kg / 16.5 lb		16 kg / 35.3 lb	
Shipping Weight	7 kg / 15.4 lb		8.5 kg / 18.7 lb		18 kg / 39.7 lb	