

CATALOG NUMBER	NOMINAL CAPACITY (mL)	MATERIALS	
		TUBE	CLOSURE
374222	5mL	PP	PP
374223	2mL	PP	PP

	374222		374223	
	INCH	MM	INCH	MM
A.....	3.578 ± .018	90.9 ± 0.46	1.923 ± .009	48.8 ± 0.23
B (TUBE HT.).....	3.212 ± .012	81.6 ± 0.30	1.556 ± .008	39.5 ± 0.20
C (TUBE O.D.).....	.493 ± .006	12.5 ± 0.15	.493 ± .006	12.5 ± 0.15
D (TUBE I.D.).....	.410 ± .006	10.4 ± 0.15	.410 ± .006	10.4 ± 0.15
E (DIA).....	.452 ± .006	11.5 ± 0.15	.452 ± .006	11.5 ± 0.15
F (DIA).....	.448 ± .009	11.4 ± 0.15	.448 ± .009	11.4 ± 0.23
G (ACROSS FLATS).....	.453 ± .006	11.5 ± 0.15	.453 ± .006	11.5 ± 0.15
PART WT. w/ CAP (gms.).....		3.7 ± 0.3		2.1 ± 0.2

1. ALL DIMENSIONS ARE NOMINAL AND IN INCHES AND MILLIMETERS UNLESS OTHERWISE NOTED.
2. THIS IS NOT A PRODUCTION DRAWING, BUT IS FOR INFORMATIONAL PURPOSES ONLY, AND IS SUBJECT TO CHANGE WITHOUT NOTICE.

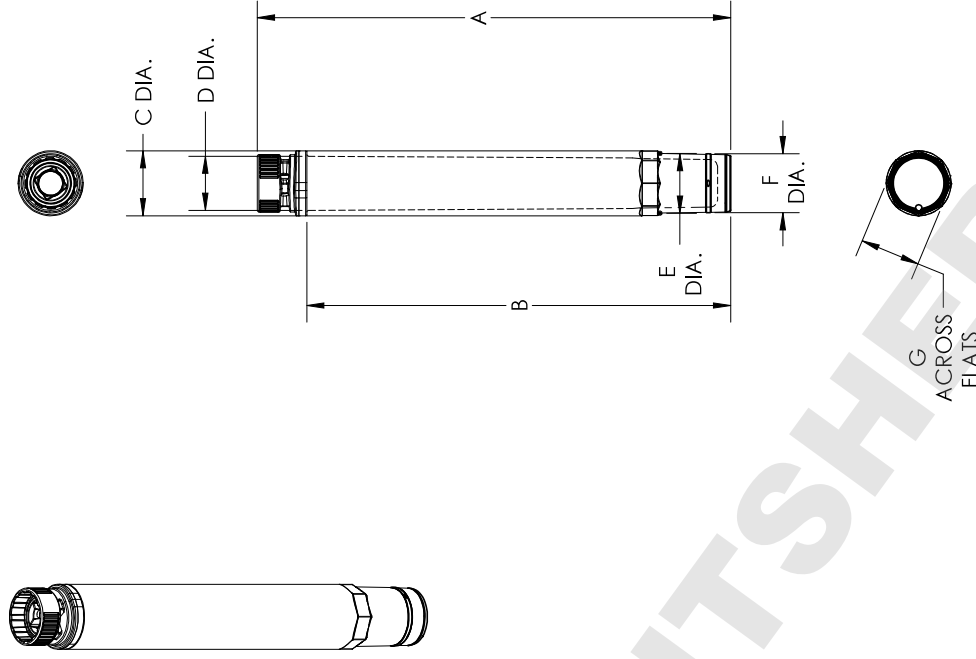

SPECS ON BACK

NOT TO SCALE

**ThermoFisher**  
S C I E N T I F I C

Thermo Fisher Scientific  
75 Pancrama Creek Drive  
Rochester, NY 14625-2385, USA

NAME PB GRP  
TITLE KOW 2/8/11  
DESCRIPTION:

PSS 37422X  
REV. 0211

CRYOBANK TUBES

**CONFIDENTIAL**

THIS PRODUCT SPECIFICATION SHEET  
CONTAINS CONFIDENTIAL AND/OR  
PROPRIETARY INFORMATION AND  
IS TO BE USED ONLY FOR THE  
EXPRESSED PURPOSES AGREED UPON  
BY AN AUTHORIZED OFFICER OF  
THERMO FISHER SCIENTIFIC.