

This drawing is a technical drawing and is not intended to be used for manufacturing purposes. It is the responsibility of the user to ensure that the drawing is used for the intended purpose and that all dimensions and tolerances are correctly interpreted.

**ENGRAVING DETAILS**

ALL CHARACTERS TO BE RAISED 0.30  
NUMBERS TO BE 2.5 HIGH  
LETTERS TO BE 3.0 HIGH

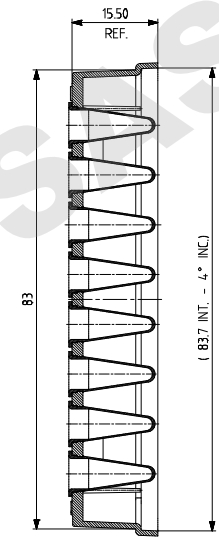
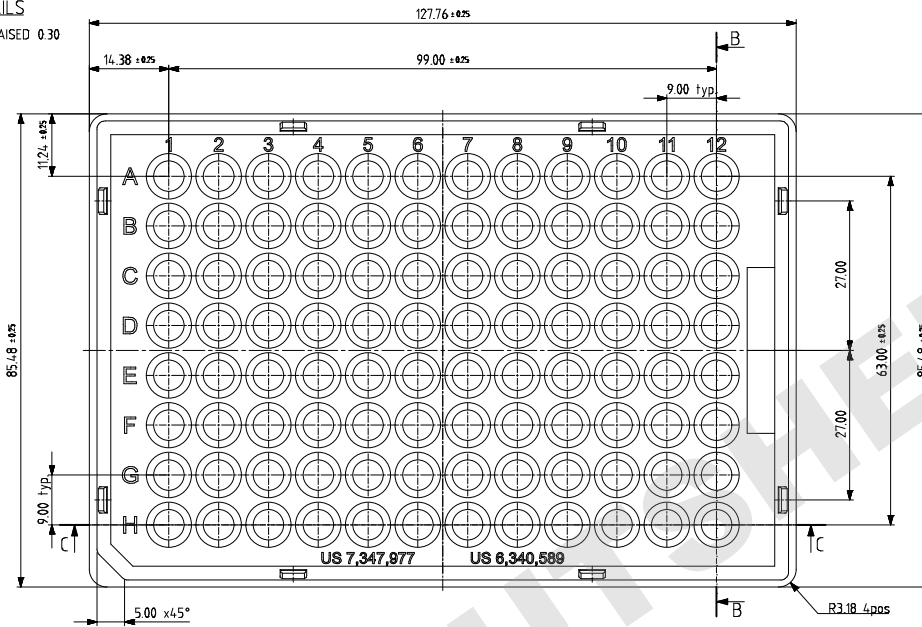
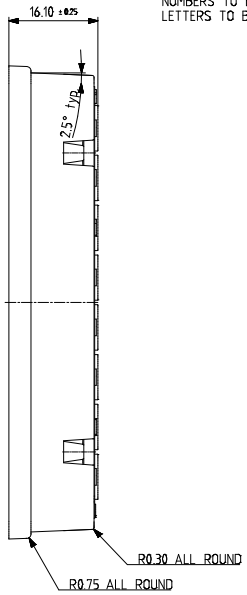

SECTION B-B

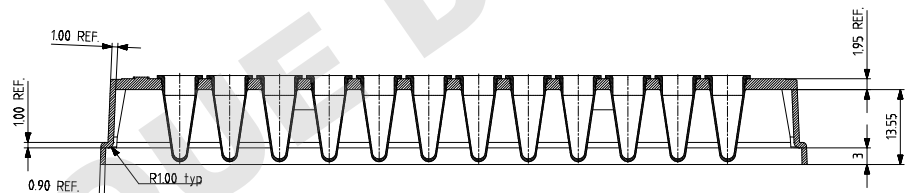

SECTION C-C

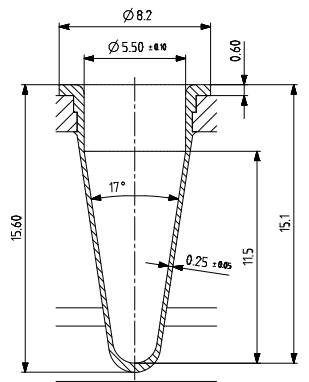

VIAL FORM 96pos.  
SCALE 10:1

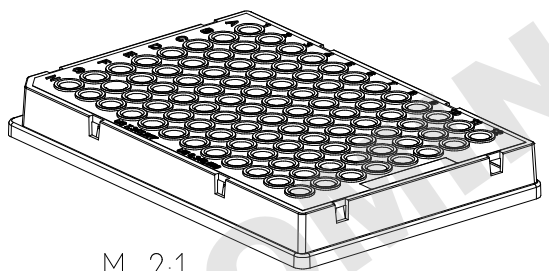

M 2:1

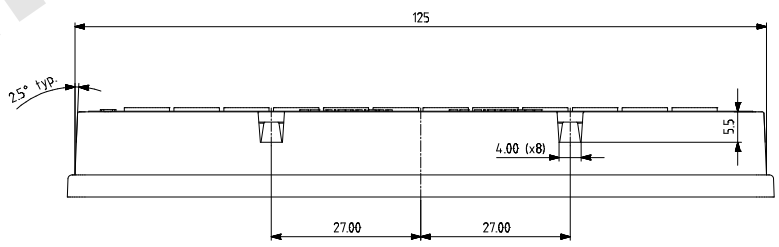

Code	Description	Plates/Case
4i-0960	FrameStar® 96 well skirted PCR plate, clear wells, purple frame	50
4i-0960/B	FrameStar® 96 well skirted PCR plate, clear wells, blue frame	50
4i-0960/C	FrameStar® 96 well skirted PCR plate, clear wells, clear frame	50
4i-0960/G	FrameStar® 96 well skirted PCR plate, clear wells, green frame	50
4i-0960/R	FrameStar® 96 well skirted PCR plate, clear wells, red frame	50
4i-0960/X	FrameStar® 96 well skirted PCR plate, clear wells, black frame	50
4i-0961	FrameStar® 96 well skirted PCR plate, white wells, black frame	50
4i-0960/0565	Combination of FrameStar® 96 well purple frame (4i-0960) + Q-stick seal (4i-0565)	50 + 50

REV	DATE	DESCRIPTION	REV	DATE	DESCRIPTION



 DO NOT SCALE IF IN DOUBT ASK	<b>CUSTOMER:</b> CUSTOMER DRG. No.: MATERIAL: FRAME: Polycarbonate, TUBES: Polypropylene TOLERANCES: GENERAL TOLERANCES UNLESS OTHERWISE STATED	<b>DRAWN:</b> ZOLTAN E. <b>DATE:</b> 14.10.2014 <b>CHECKED:</b> JAMES B. <b>DATE:</b> <b>SCALE:</b>	<b>TITLE:</b> FrameStar® 96 Skirted Marketing drawing <b>DRAWING No.:</b> 4i-0960 <b>SHEET No.:</b> 1 OF 1 <b>ISSUE:</b> E
-------------------------------------	---	---	---