

NAO[®] Basket

FOR RAPID AND EFFICIENT DNA RECOVERY



NAO[®] Basket

NUCLEIC ACID OPTIMIZER

The **NAO[®] Basket (Nucleic Acid Optimizer)** semi-permeable basket is a **fast and highly efficient system for releasing and concentrating all human DNA** from swab samples, card punches or other specimens.

NAO[®] Basket, coupled with a 2mL or 1.5mL microtube, enables to perform in one simple procedure the sample lysis and the provides optimal recovery of DNA.

NAO[®] Basket used with COPAN **FLOQSwabs[®]** allows the complete release of all the sample collected by the swab, particularly critical for crime scene evidence testing.



PLUS FEATURES:

- 1 FORENSIC DNA GRADE:** Free of amplifiable human DNA, Free of detectable DNase and RNase, EtO treated.
- 2 LYSE&CENTRIFUGE IN THE BASKET:** innovative product design allows the passage of DNA from samples into the tube using a grid bottom, and tight leak-proof design can endure vortexing, centrifugations and various storage conditions.
- 3 INCREASED DNA YIELD** particularly when combined with FLOQSwabs[®]
- 4 DECREASED RISK OF SAMPLE CONTAMINATION:** significant reduction of manual manipulation of the sample.
- 5 COMPATIBILITY:** NAO[®] Basket is compatible with commercial Nucleic Extraction Platforms



Innovating Together™

copangroup.com



NAO[®]Basket

MAXIMIZE DNA YIELD

Laboratory tests show an increased recovery rate of DNA by processing the sample with NAO[®]Basket in comparison with standard procedures. The **combination of NAO[®]Basket and FLOQSwabs[®] provides more than 90% DNA recovery** of the reference sample.

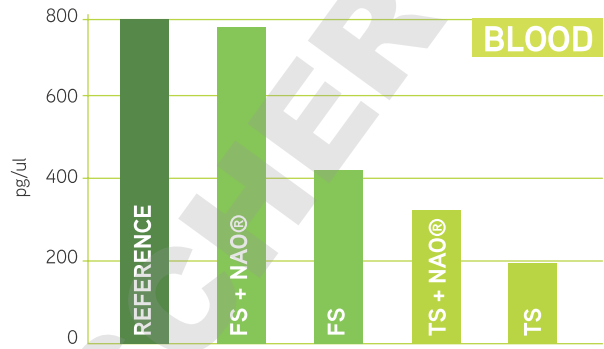
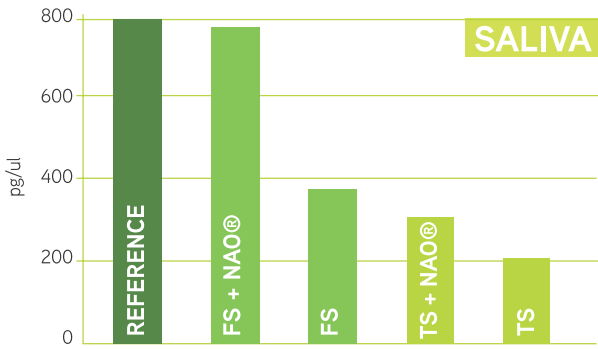

Above data show DNA recovery obtained from saliva and blood samples spiked on FLOQSwabs[®] (FS) and Traditional fiber swabs (TS) and then processed with and without the NAO[®]Basket (NAO[®])¹.

EASY TO USE

- **SAMPLE:** Break the FLOQSwabs[®] at the breaking point into the NAO[®]Basket
- **LYSE:** Add the lysis buffer and incubate as per extraction kit instructions.
- **TEST:** Upon centrifugation, the sample lysate passes through the basket and is available for testing at the bottom of the tube.

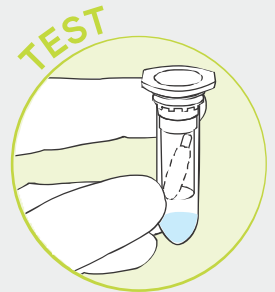
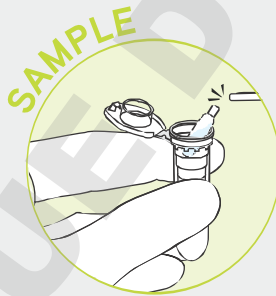

Extraction kit specific protocol can be provided upon request. Please refer to complete instructions and how-to-use guide. Above pictograms are for marketing demonstration only.



NAO[®]Basket is produced in compliance with ISO 18385:2016 (E)

¹ Copan internal testing



COPAN ITALIA SPA

Via F. Perotti 10
25125 - Brescia,
Italy

t. +39 030 2687211
f. +39 030 2687250
customer@copangroup.com
www.copangroup.com