

| CATALOG NO. | NOMINAL CAPACITY, (nL) |     |     |     |      | MATERIALS |         |
|-------------|------------------------|-----|-----|-----|------|-----------|---------|
|             | 50                     | 100 | 250 | 500 | 1000 | FLASK     | CLOSURE |
| 004001      |                        |     |     |     |      | PMP       | PP      |

| SIZE CODE                         | -0050 |      | -0100 |      | -0250 |     |
|-----------------------------------|-------|------|-------|------|-------|-----|
| NOM. CAP., (nL)                   | 50    |      | 100   |      | 250   |     |
| CLOSURE SIZE (mm)                 | 13    |      | 20    |      | 20    |     |
| NOMINAL WEIGHT WITH CLOSURE (gms) | 15    |      | 20    |      | 40    |     |
|                                   | INCH  | MM   | INCH  | MM   | INCH  | MM  |
| A (NECK I.D. AT TOP)              | 0.3   | 7.6  | 0.5   | 13   | 0.5   | 13  |
| B (NECK O.D.)                     | 0.46  | 11.7 | 0.6   | 15   | 0.7   | 18  |
| C (BULB DIA)                      | 1.82  | 46.2 | 2.18  | 55.4 | 3.0   | 76  |
| D (HT W/O CLOSURE)                | 5.7   | 145  | 7.4   | 188  | 8.8   | 224 |
| H (HT WITH CLOSURE)               | 5.8   | 147  | 7.5   | 191  | 8.9   | 226 |

| SIZE CODE                         | -0500 |       | -1000 |     |
|-----------------------------------|-------|-------|-------|-----|
| NOM. CAP., (nL)                   | 500   |       | 1000  |     |
| CLOSURE SIZE (mm)                 | 24    |       | 28    |     |
| NOMINAL WEIGHT WITH CLOSURE (gms) | 70    |       | 110   |     |
|                                   | INCH  | MM    | INCH  | MM  |
| A (NECK I.D. AT TOP)              | 0.7   | 18    | 0.8   | 20  |
| B (NECK O.D.)                     | 0.8   | 20    | 0.9   | 23  |
| C (BULB DIA)                      | 3.7   | 94    | 4.7   | 119 |
| D (HT W/O CLOSURE)                | 10.8  | 273.1 | 12.3  | 312 |
| H (HT WITH CLOSURE)               | 10.9  | 269   | 12.4  | 315 |

- NOTES:
1. ALL DIMENSIONS ARE NOMINAL AND IN INCHES AND MILLIMETERS UNLESS OTHERWISE NOTED.
  2. THIS IS NOT A PRODUCTION DRAWING, BUT IS FOR INFORMATIONAL PURPOSES ONLY, AND IS SUBJECT TO CHANGE WITHOUT NOTICE.

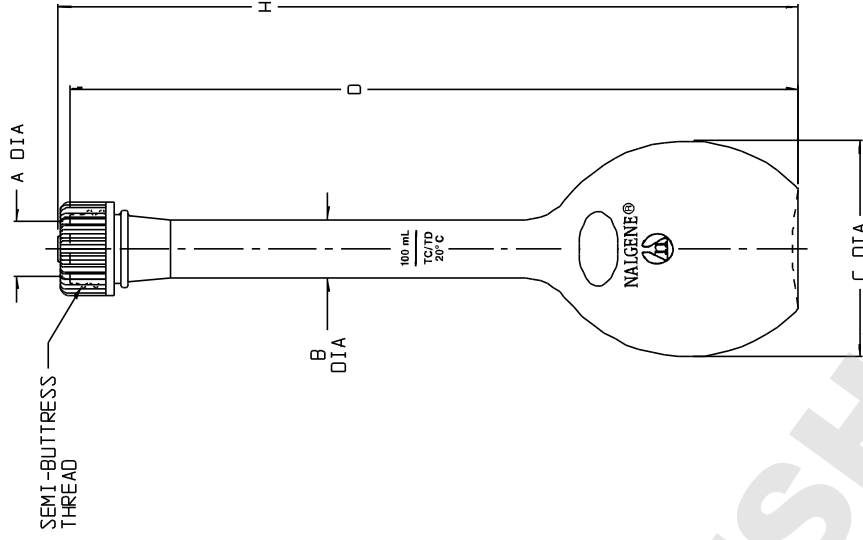

SPECS ON BACK

NOT TO SCALE

**ThermoFisher**  
**SCIENTIFIC**

Thermo Fisher Scientific  
75 Pancoro Creek Drive  
Rochester, NY 14625-2385, USA

|             |         |     |              |
|-------------|---------|-----|--------------|
| NAME        | MC-2    | REV | 0103         |
| DATE        | 1/13/03 | PSS | 00-4001-XXXX |
| DESCRIPTION | PVC     |     |              |

VOLUMETRIC FLASKS

CONFIDENTIAL

THIS PRODUCT SPECIFICATION SHEET CONTAINS CONFIDENTIAL AND/OR PROPRIETARY INFORMATION AND IS TO BE USED ONLY FOR THE EXPRESSED PURPOSES AGREED UPON BY AN AUTHORIZED OFFICER OF THERMO FISHER SCIENTIFIC.