

CATALOG NO.	NOMINAL CAPACITY, (nL)					MATERIALS	
	50	100	250	500	1000	FLASK	CLOSURE
004001						PMP	PP

SIZE CODE	-0050		-0100		-0250	
NOM. CAP., (nL)	50	100	100	100	250	250
CLOSURE SIZE (mm)	13	20	20	20	20	20
NOMINAL WEIGHT WITH CLOSURE (gms)	15	20	20	20	40	40
	INCH	MM	INCH	MM	INCH	MM
A (NECK I.D. AT TOP)	0.3	7.6	0.5	13	0.5	13
B (NECK O.D.)	0.46	11.7	0.6	15	0.7	18
C (BULB DIA)	1.82	46.2	2.18	55.4	3.0	76
D (HT W/O CLOSURE)	5.7	145	7.4	188	8.8	224
H (HT WITH CLOSURE)	5.8	147	7.5	191	8.9	226

SIZE CODE	-0500		-1000	
NOM. CAP., (nL)	500	1000	1000	1000
CLOSURE SIZE (mm)	24	28	28	28
NOMINAL WEIGHT WITH CLOSURE (gms)	70	110	110	110
	INCH	MM	INCH	MM
A (NECK I.D. AT TOP)	0.7	18	0.8	20
B (NECK O.D.)	0.8	20	0.9	23
C (BULB DIA)	3.7	94	4.7	119
D (HT W/O CLOSURE)	10.8	273.1	12.3	312
H (HT WITH CLOSURE)	10.9	269	12.4	315

- NOTES:
1. ALL DIMENSIONS ARE NOMINAL AND IN INCHES AND MILLIMETERS UNLESS OTHERWISE NOTED.
 2. THIS IS NOT A PRODUCTION DRAWING, BUT IS FOR INFORMATIONAL PURPOSES ONLY, AND IS SUBJECT TO CHANGE WITHOUT NOTICE.

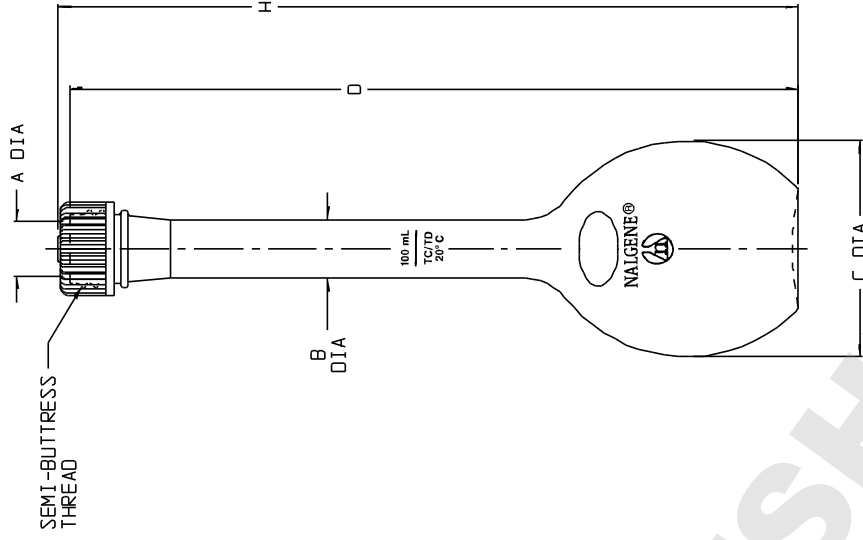

SPECS ON BACK

NOT TO SCALE

ThermoFisher
SCIENTIFIC

Thermo Fisher Scientific
75 Pancromo Creek Drive
Rochester, NY 14625-2385, USA

NAME: MC-2 PVC
REV: 1/13/03

PSS 00-4001-XXXX

REV: 0103

VOLUMETRIC FLASKS

CONFIDENTIAL

THIS PRODUCT SPECIFICATION SHEET CONTAINS CONFIDENTIAL AND/OR PROPRIETARY INFORMATION AND IS TO BE USED ONLY FOR THE EXPRESSED PURPOSES AGREED UPON BY AN AUTHORIZED OFFICER OF THERMO FISHER SCIENTIFIC.