

CATALOG NO.	NOMINAL SIZE (mm)		MATERIAL
342151	20	38-430	HOPE

SIZE CODE.....	-0200	-0240	-0384
THREAD FINISH (mm) :	20-415	24-415	38-430
THREAD (T.P.I.).....	8	8	6
NOM. WEIGHT (gms)...	2	2.5	10
	INCHES	MM	INCHES
D (DIA).....	0.96 ±0.02	24.4 ±0.5	1.12 ±0.03
H (HEIGHT).....	0.60 ±0.03	15.2 ±0.8	0.60 ±0.03
	MM	MM	MM
	0.96 ±0.02	24.4 ±0.5	1.12 ±0.03
	0.60 ±0.03	15.2 ±0.8	0.60 ±0.03
	1.66 ±0.03	42.2 ±0.8	1.17 ±0.03
	1.66 ±0.03	42.2 ±0.8	1.17 ±0.03

NOTES:

1. ALL DIMENSIONS ARE NOMINAL AND IN INCHES AND MILLIMETERS UNLESS OTHERWISE NOTED.
2. THIS IS NOT A PRODUCTION DRAWING, BUT IS FOR INFORMATIONAL PURPOSES ONLY, AND IS SUBJECT TO CHANGE WITHOUT NOTICE.

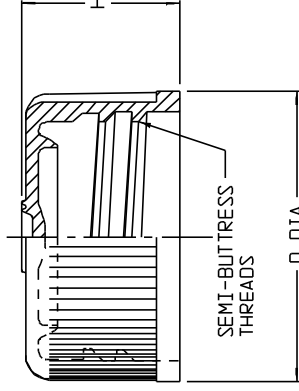

NOT TO SCALE

SPECS ON BACK

NOT TO SCALE

ThermoFisher
SCIENTIFIC

Thermo Fisher Scientific
75 Pancromo Creek Drive
Rochester, NY 14625-2385, USA

NAME	DATE	REV.
PB PVC	12/18/02	1202
PVC		

PSS 34-2151-OXXX

SCREW CLOSURES

CONFIDENTIAL

THIS PRODUCT SPECIFICATION SHEET CONTAINS CONFIDENTIAL AND/OR PROPRIETARY INFORMATION AND IS TO BE USED ONLY FOR THE EXPRESSED PURPOSES AGREED UPON BY AN AUTHORIZED OFFICER OF THERMO FISHER SCIENTIFIC.