

## Polycarbonate Cryogenic Boxes

### I. APPLICATIONS

1. Storage and organization of any range of 1.5ml to 5.0ml microtubes/cryogenic vials

### II. FEATURES

1. Materials: durable polycarbonate
2. Chemically resistant to alcohols and mild organic solvents
3. Temperature range: stable from -196°C to 121°C (Autoclavable)
4. Polycarbonate box is suitable for liquid nitrogen storage

### III. BOX DESIGN

1. 9x9 well storage (81-wells total), 10x10 well storage (100-wells total) & 5x5 well storage (25-wells total)
2. 5 assorted colors: white, red, yellow, green, and blue
3. Holds 1.5ml , 2.0ml microtubes or 5ml cryogenic vials
4. Removable lid includes a numbered grid for orientation

### IV. PACKAGING

1. 81-well and 100-well: Bulk, 20 boxes/case, assorted colors  
25-well: Bulk, 30 boxes/case, assorted colors

### V. DESCRIPTION

Item	Description	Packaging	Sterile
90-9009	Polycarbonate 81-well Cryogenic storage box	Bulk, 5 /bag, 4 bags/case, assorted colors	No
90-9210	Polycarbonate 100-well Cryogenic storage box	Bulk, 5 /bag, 4 bags/case, assorted colors	No
90-9250	Polycarbonate 25-well Cryogenic storage box	Bulk, 5 /bag, 6 bags/case, assorted colors	No
90-9381	Polycarbonate 81-well Cryogenic storage box	Bulk, 5 /bag, 4 bags/case, assorted colors	No

### VI. STERILITY

1. N/A

### VII. CERTIFICATION

Biologix products are manufactured completely according to the TUV ISO 9001:2015 standard.

## VIII. RESTRICTIONS

Refer to the Chemical Resistance Chart in our catalog, and available within our online catalog.

## IX. PRODUCT PHOTOS



**90-9009**



**90-9210**



**90-9250**



**90-9381**

**X. PRODUCT PARAMETER**

Dimensions=mm

Cat #	Description	A	B	C	D	E	F	G
90-9009	Box	132.0	12.2	35.0	30.0	26.0	16.5	132.0
90-9009C	Lid	132.0	132.0	26.0	-	-	-	-

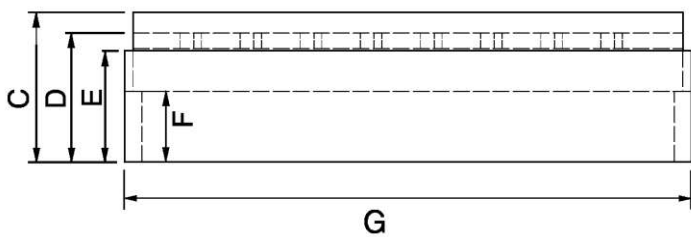
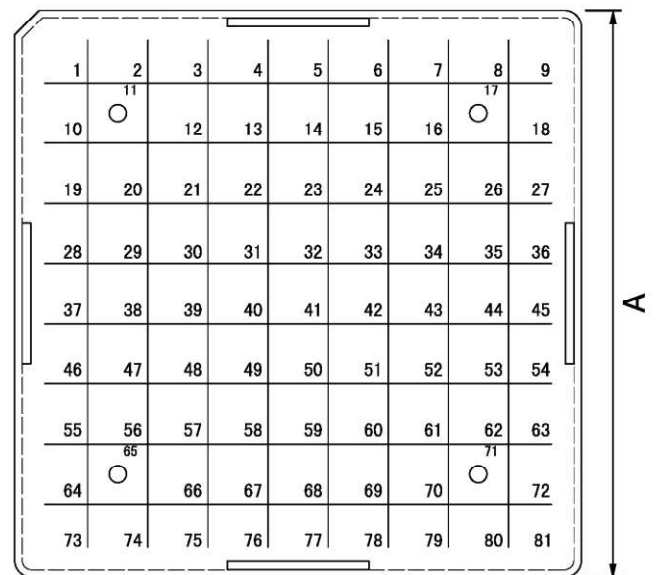
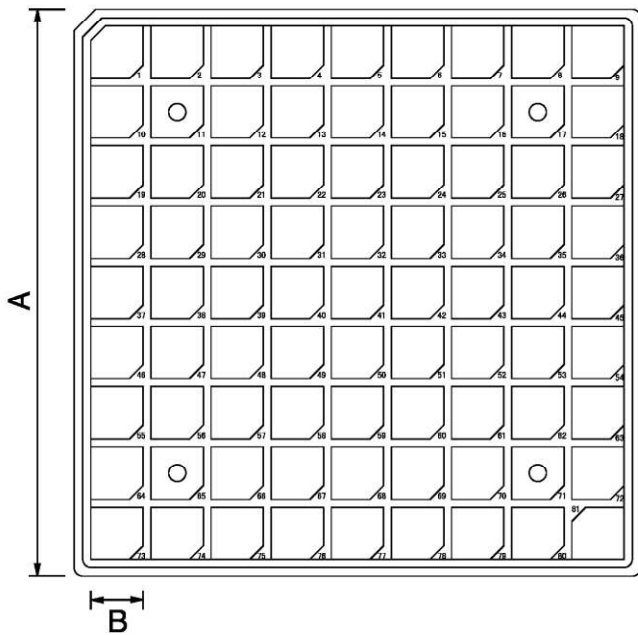

90-9009

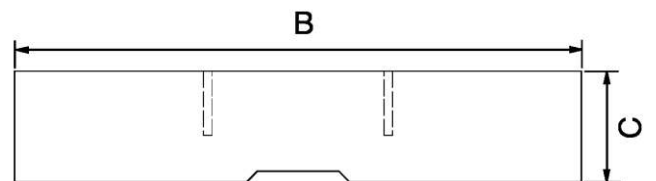

90-9009C

**Dimensions=mm**

Cat #	Description	A	B	C	D	E	F	G
90-9250	Box	75.7	12.2	35.0	30.0	26.0	16.5	75.7
90-9250C	Lid	75.7	75.7	26.0	-	-	-	-

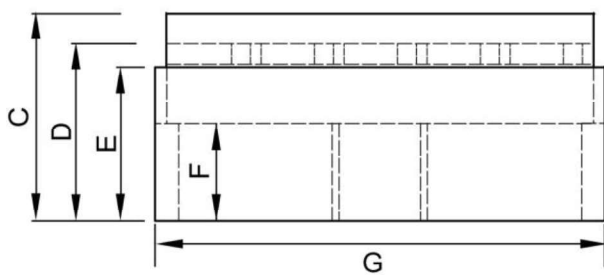
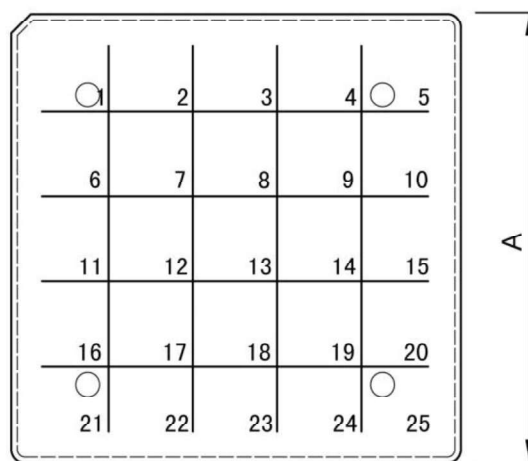
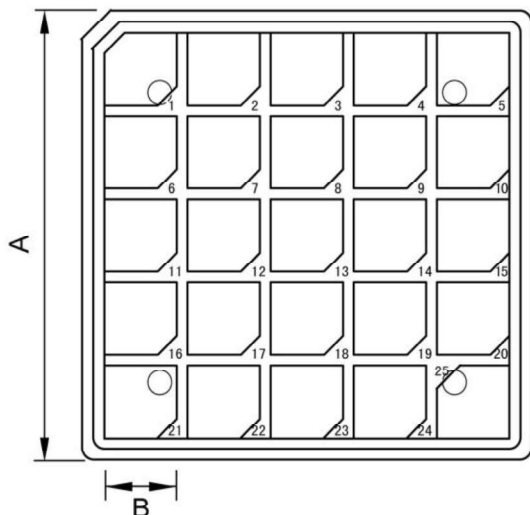

90-9250

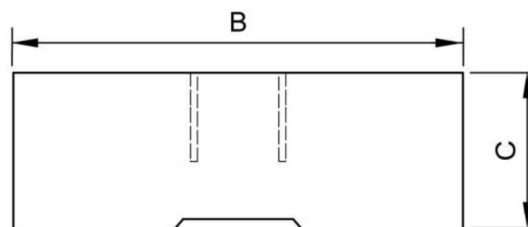

90-9250C

**Dimensions=mm**

Cat #	Description	A	B	C	D	E	F	G
<b>90-9210</b>	Box	132	129.7	130.7	12.6	31.3	26.4	4.9
		<b>H</b>	<b>I</b>	<b>J</b>	<b>K</b>	L		
<b>90-9210C</b>	Lid	132.5	26.7	25.0	38.4	84.7		

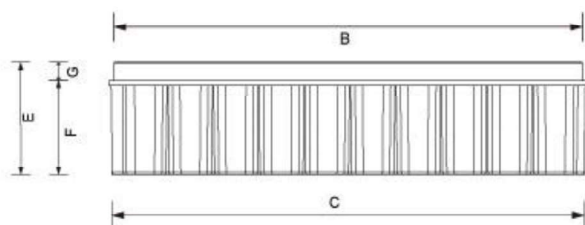
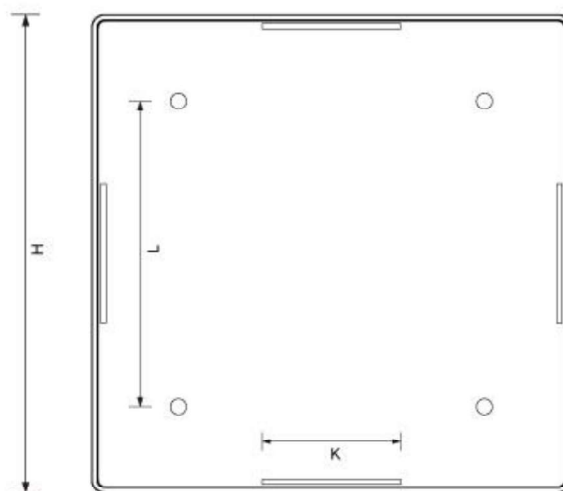
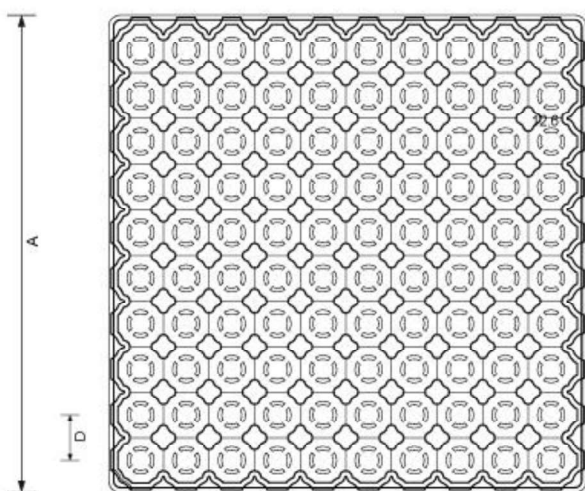

Dimensions=mm

Cat #	Description	A	B	C	D	E
90-9381	Box	132.5	95	35	132.5	12.2

