

GCA W986336NG

ALL DIMENSIONS ARE IN MILLIMETERS AND (INCHES).
 UNLESS OTHERWISE SPECIFIED, DIMENSIONS ARE TO BE HOLD.
 DIMENSIONS IN PARENTHESES ARE FOR REFERENCE ONLY.
 DIMENSIONS IN BRACKETS ARE FOR REFERENCE ONLY.
 DIMENSIONS IN SQUARE BRACKETS ARE FOR REFERENCE ONLY.
 DIMENSIONS IN CIRCLES ARE FOR REFERENCE ONLY.
 DIMENSIONS IN TRIANGLES ARE FOR REFERENCE ONLY.

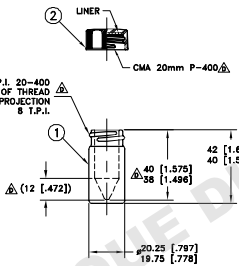

PRODUCT COMPONENTS		
ITEM	QTY	DESCRIPTION
1.	12	2.0mL V-VIAL
2.	12	20-400 CAP WITH LINER

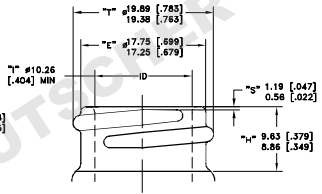

FINISH DETAIL
 SCALE 4 X 1

- ▲ VIAL IS A PATENTED DESIGN
 DO NOT DUPLICATE | US D544,
 764 S
- ▲ CAP MATERIAL: BLACK PHENOLIC
- ▲ LINER MATERIAL AND THICKNESS: 1.27 [.050] 14B
 0.13 [.005] PTFE
- ▲ VIAL MATERIAL: TYPE I AMBER, BOROSILICATE GLASS
 20mm TUBING 3.2mm WALL

D	201404011017181	04/08/14 TP
C	201110211112772	01/10/12 TP
B	20080331083034	05/15/08 RL
A	20071206154852	06/11/06 TRJ

TITLE	2.0mL V-VIAL, AMB, 20-400 S/T, CAP	DATE ISSUED	01/11/08	FIELD	
CAPACITY	2.0mL	SIZE	20 X 41mm	DESIGNED BY	TRJ
FORM	G.P.I. 20-400	CHECKED BY	BL 01/11/08	APPROVED	NRD 01/14/08
NOTES		SCALE: FULL UNLESS NOTED, DO NOT SCALE THIS DRAWING.		REV	

WHEATON® <small>THE WATSON COMPANY, MILWAUKEE, WISCONSIN, U.S.A.</small>		DWG. NO: B- W986336NG
---	--	-----------------------